



Well Valve

PN 25
DIN 3202-F1
DIN 2501
DN40...DN300



铸钢法兰过滤器
Flange Cast Steel Y-Strainer

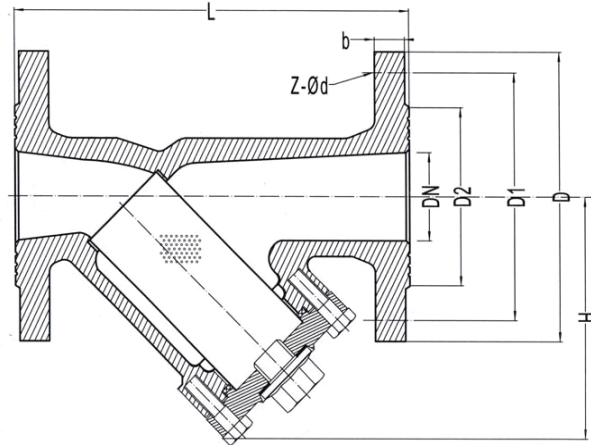

TEMPERATURE/PRESSURE

°C	-10...+120	350	450
PN 25	25	16	10

APPLICATIONS

- Hot and cold water systems
- Fluid excluding acid

MATERIALS	
PART NAME	MATERIAL
BODY	CS25
BONNET	CS25
FILTER	SS304
PLUG	CS25
GASKET	GRAPHITE

Structure

DN	L	D	D1	D2	b	Z-φb	H	KG
40	200	150	110	88	18	4-18	83	10.7
50	230	165	125	102	20	4-18	105	13.7
65	290	185	145	122	22	8-18	131	21.1
80	310	200	160	138	24	8-18	150	27.3
100	350	230	190	162	24	8-22	174	38.6
125	400	270	220	188	26	8-26	305	57.5
150	480	300	250	218	28	8-26	360	75.8
200	600	360	310	278	30	12-26	510	146
250	730	425	370	335	32	12-30	540	206
300	850	485	430	395	34	16-30	630	320

Suqian Well Valve Co., Ltd

www.wellvalve.com Email:wellvalve@wellvalve.com TEL:+86 518 85477138 FAX:+86 518 85457833